

Roller cutting machine RS

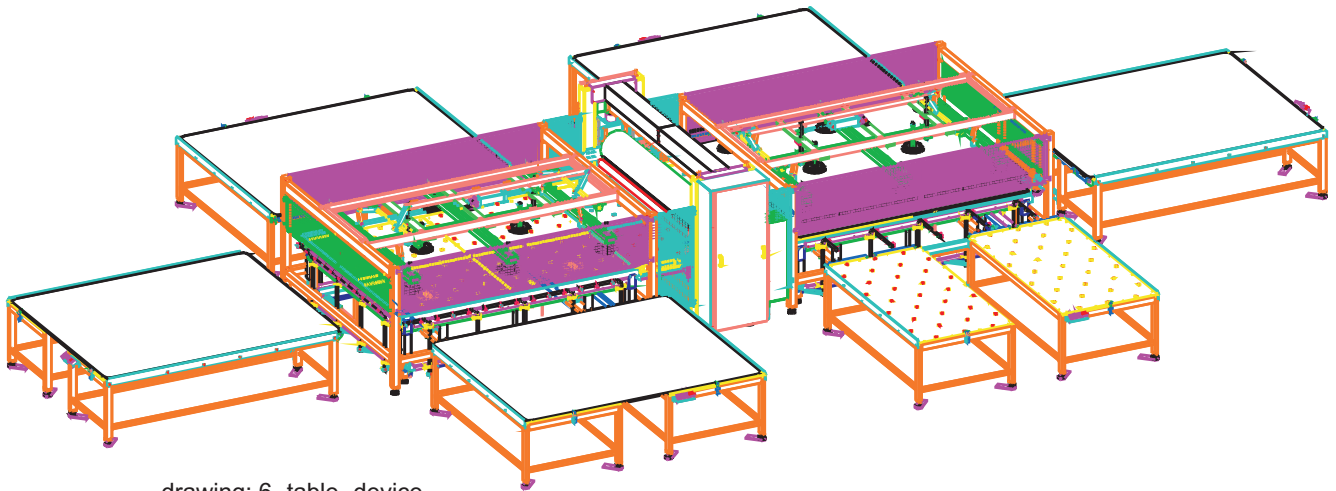

drawing: 6- table- device
RS - 2500 / 3000 / 6



RING Maschinenbau GmbH & Co. KG

Adam-Müller-Straße 74, 66954 Pirmasens, Fon: +49 (0) 6331 5181-0 Fax: +49 (0) 6331 92422

e-mail: kontakt@ring-perforating.de

homepage: www.ring-perforating.de - www.ring-stanztechnik.de

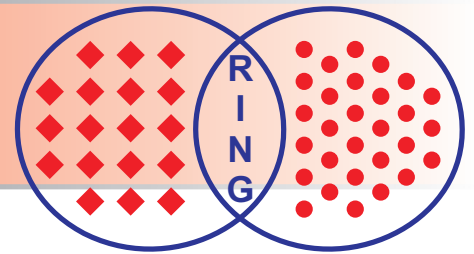

Roller cutting machine RS: electromechanically driven

Devices built for rational cutting of large scale manufacture of leather, textiles and other materials. The machine operates according to the "sandwich" system which means that materials such as leather hides, technical textiles, cloth, etc. are unrolled on a lower cutting board. Then the profile cutting dies can be positioned perfectly to avoid any waste of material. Dependent on the machine's type (4/ 6/ 8-table design), several persons can feed the device simultaneously which leads to higher production scales.

Before the lower cutting board comes into the cutting process, a second upper cutting board completes the "sandwich". Now it is transported through the 2 steel rollers which are driven separately via frequency-regulated gear motors.

In order to avoid any risk, the height of the sandwich package is controlled on both sides of the cutting area so that the machine comes to a halt when cutting dies erroneously overlap or other errors occur.

The distance between the two steel rollers is reducible to an exact size which guarantees a precise cutting process without penetrating the cutting board too deeply which would lead to an accelerated wear.

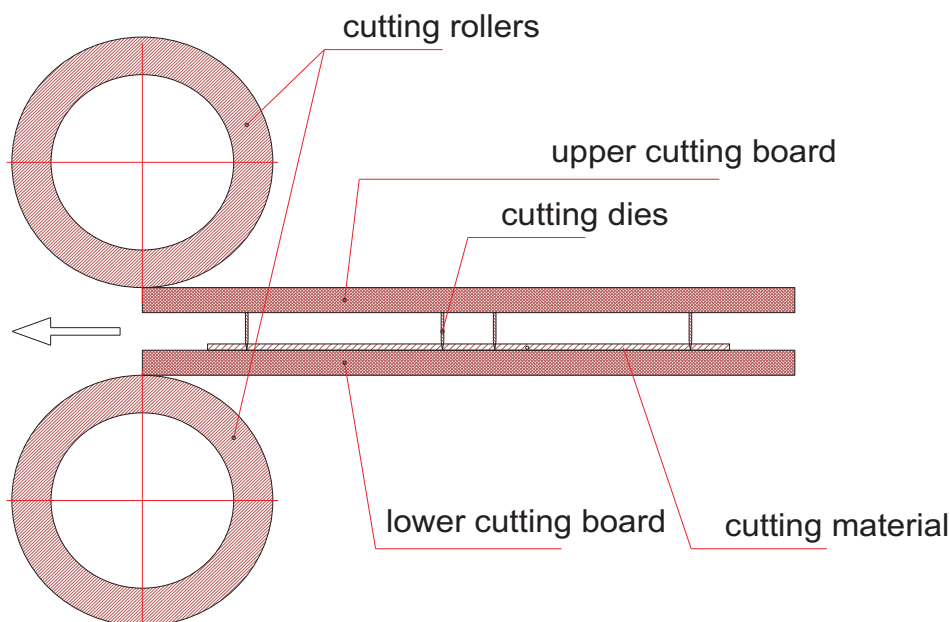

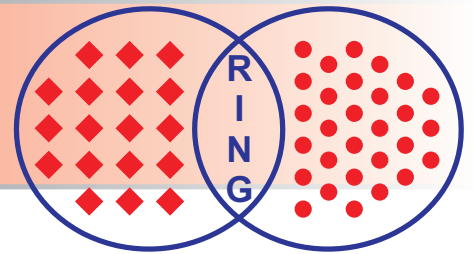

In the backward movement through the cutting- roller- unit, the upper board is lifted in a way that there are no double cuttings possible.

For every single table you can choose an adequate transport cutting measure via the operating terminal. This enables the use of cutting- boards and cutting dies of different height per table and the adjustment of an optimal penetration into the cutting- board.

Profit from cost-effective working and least wearout!

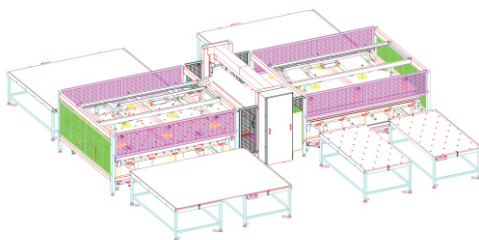

4- table- device

8- table- device

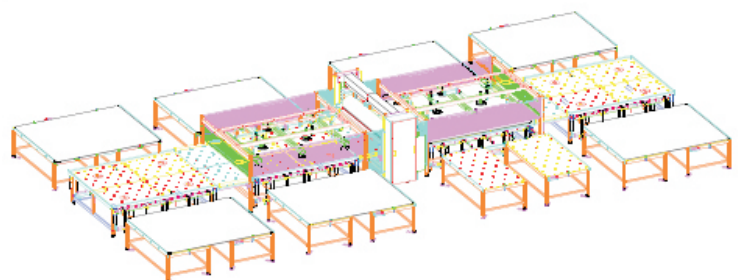

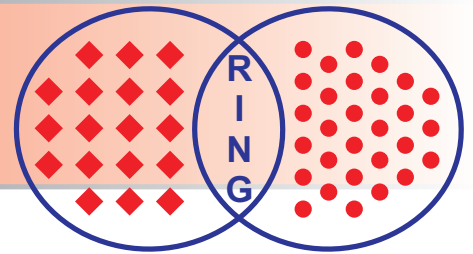

Technical data:

	RS- 1700/3000/4	RS- 1700/3000/6	RS- 1700/3000/8
cutting force	200 kN	200 kN	200 kN
steel roller width	1800 mm	1800 mm	1800 mm
usable roller width	1700 mm	1700 mm	1700 mm
steel roller diameter	400 mm	400 mm	400 mm
passage between two rollers	20 - 150 mm	20 - 150 mm	20 - 150 mm
transport speed	20 - 40 m/min	20 - 40 m/min	20 - 40 m/min
working height	780 mm	780 mm	780 mm
drive power	2 x 3,0 kW	2 x 3,0 kW	2 x 3,0 kW
number of preparation table	4	6	8
table dimensions each side	1700 x 3000 mm	1700 x 3000 mm	1700 x 3000 mm
transport/ preparation table	ca. 6 / h	ca. 6 / h	ca. 6 / h
number of lifting devices	2	2	2
number of cover boards	1	wahlweise 1 oder 2	2
machine dimension (LxWxH)	8,5 x 7,0 x 2,3 m	16,5 x 7,0 x 2,3 m	16,5 x 7,0 x 2,3 m
operating voltage	14,0 kW/ 400 V/ 50 Hz	14,0 kW/ 400 V/ 50 Hz	17,0 kW/ 400 V/ 50 Hz
	RS- 2500/3000/4	RS- 2500/3000/6	RS- 2500/3000/8
cutting force	200 kN	200 kN	200 kN
steel roller width	2600 mm	2600 mm	2600 mm
usable roller width	2500 mm	2500 mm	2500 mm
steel roller diameter	400 mm	400 mm	400 mm
passage between two rollers	20 - 150 mm	20 - 150 mm	20 - 150 mm
transport speed	20 - 40 m/min	20 - 40 m/min	20 - 40 m/min
working height	780 mm	780 mm	780 mm
drive power	2 x 3,0 kW	2 x 3,0 kW	2 x 3,0 kW
number of preparing table	4	6	8
table dimensions each side	2500 x 3000 mm	2500 x 3000 mm	2500x3000 mm
transport/ preparation table	ca. 6 / h	ca. 6 / h	ca. 6 / h
number of lifting devices	2	2	2
number of cover boards	1	wahlweise 1 oder 2	2
machine dimension (LxWxH)	8,5 x 9,0 x 2,3 m	16,5 x 9,0 x 2,3 m	16,5 x 9,0 x 2,3 m
operating voltage	14,0 kW/ 400 V/ 50 Hz	14,0 kW/ 400 V/ 50 Hz	17,0 kW/ 400 V/ 50 Hz